

SNAP FRAME INSTRUCTIONS OPTION A

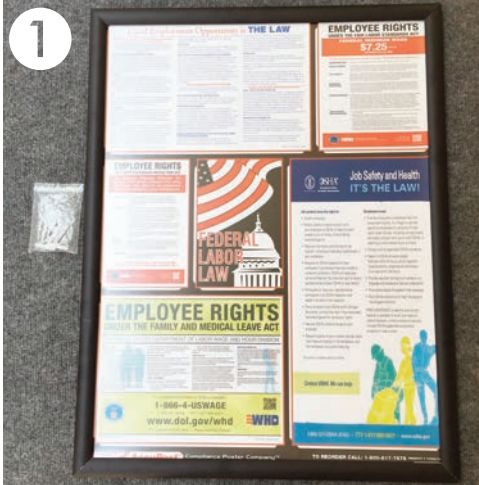

1
Open the box and take out your framed poster with the provided contents: plastic bag with wall screws and anchors. (Wire not included)



2
Locate a blank wall area for your framed poster to hang.



3
Open the left and right sides of the frame and locate the frame's pre-drilled holes.

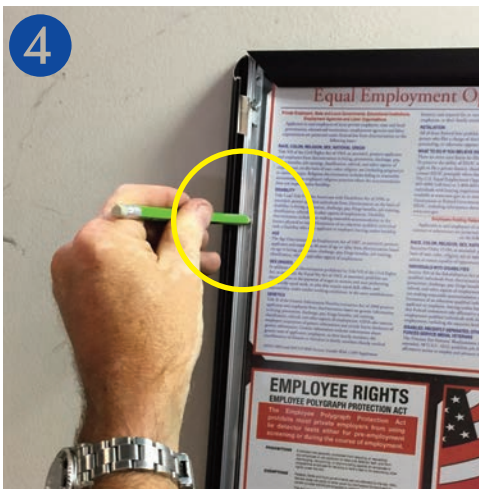

4
With a pencil, mark the holes on both the left and right sides of the frame.



5
With a screwdriver (Phillips/X), drive the screwdriver into the wall where you marked the left and right holes.

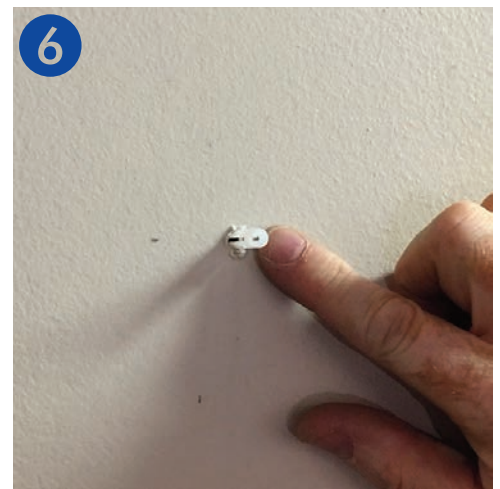

6
Push the white plastic wall anchor into the wall.



7
Take the provided screw and feed it through the frame to match up to the wall anchor. Using your screwdriver, drive the screw into the wall.



8
Do this for the right side also. Then snap the frame closed on both sides.



9
Your framed poster should be mounted to the wall as above.

SNAP FRAME INSTRUCTIONS OPTION B

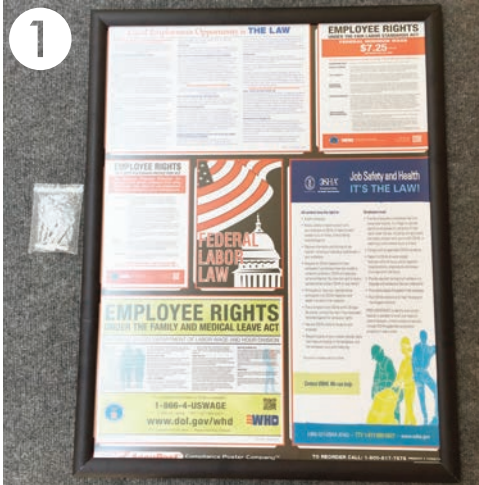

Open the box and take out your framed poster with the provided contents: plastic bag with wall screws and anchors. (Wire not included)

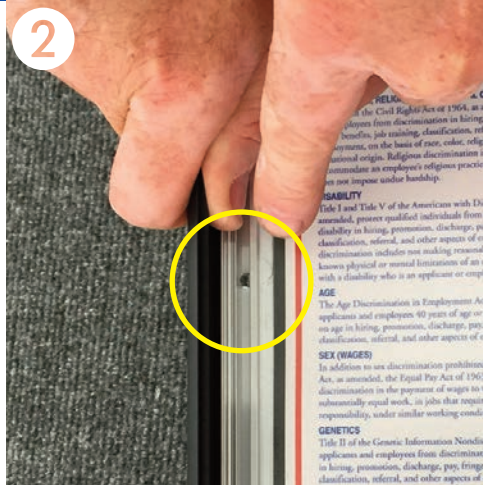

Open the left and right sides of the frame, and locate the frame's pre-drilled holes.

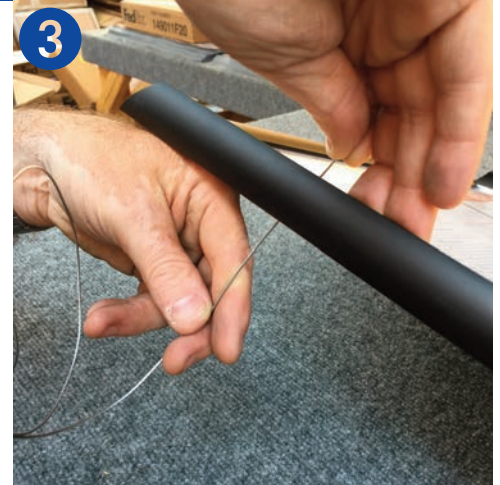

Beginning with the left side, feed the wire through the frame's hole.

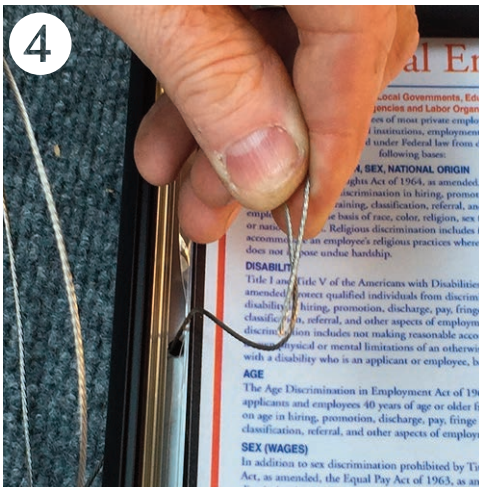

Feed approximately 6" through the hole, then make a loop back on itself.

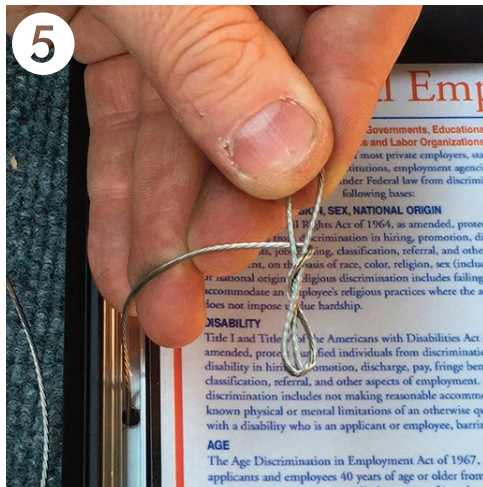

Twist the wire into another loop, creating a T shape.

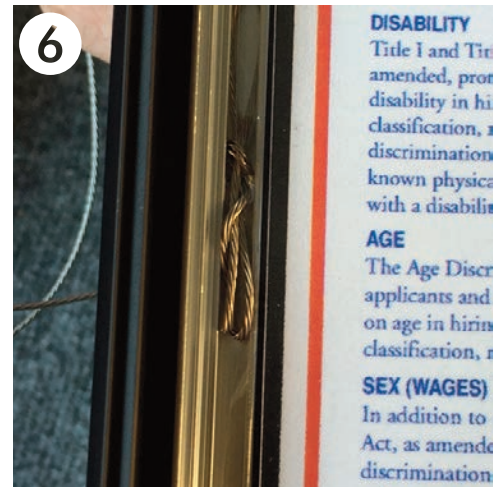

Pull the wire from the back so the T shape is flush with the frame.

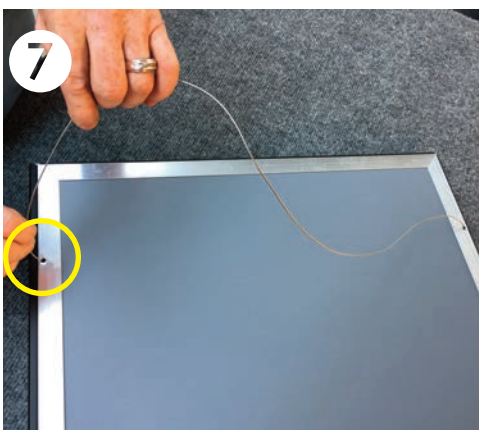

Feed the rest of the wire to the other side of the frame and pull the wire through the frame's hole, back to front.



With the rest of the wire repeat steps 4 to 6 to right side of the frame. Snap the frame close on both sides.



Your frame is ready to hang from a single wall-mounted screw.

SNAP FRAME INSTRUCTIONS OPTION C



1
Locate the 4 double sided adhesive strip stickers.

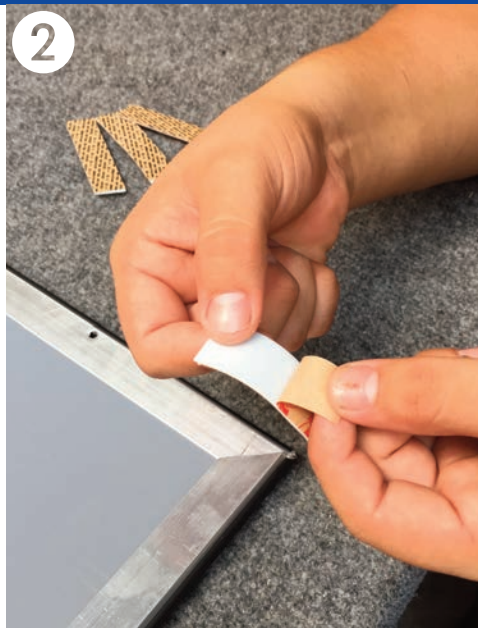

2
One at a time, take one of the stickers and peel off the backing.

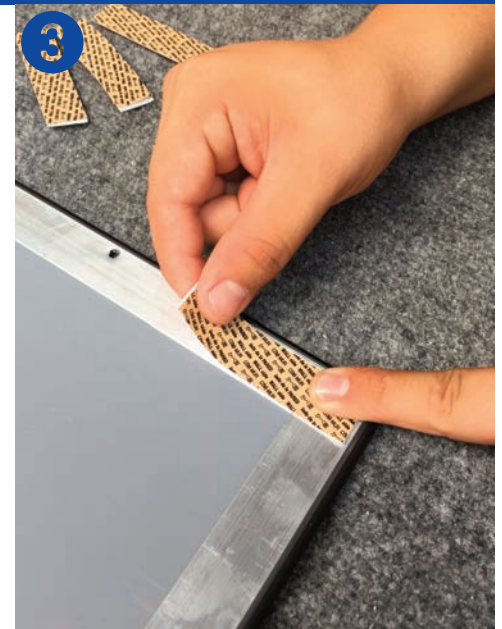

3
Hold one side of the sticker down to the frame as you press the rest to it.

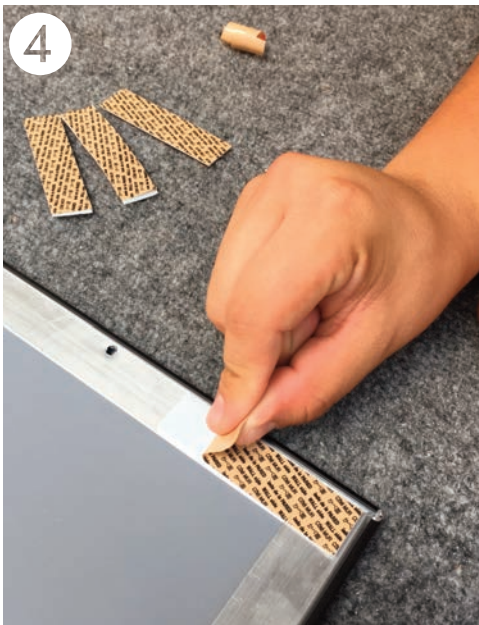

4
Peel back the second backing to the sticker.
Repeat this process for the rest of the stickers for all four corners of the frame.



5
Your frame should look like this when done.



6
Press the frame to the door or surface of a wall.



If you have any questions or concerns, please call this number:

1-800-817-7678